

RCDD Version 14.1 Exam

1. What is the MINIMUM clearance needed between the front of the telephone booth and any wall or fixture for most installations?

A. 300 mm (12 in)

B. 450 mm (18 in)

C. 610 mm (24 in)

D. 914 mm (36 in)

E. 2.4 m (8 ft)

Answer(s): C

2. Exhibit:

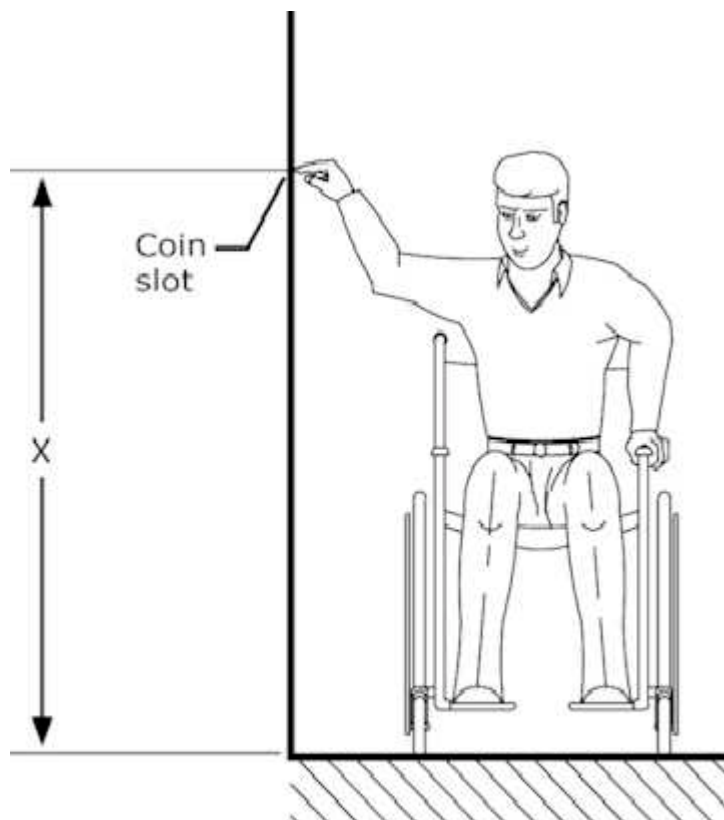

Side reach limits

A pay telephone using coins needs to be installed in a public area

A. In the specifications, it is required that the telephone shall meet the ADA (Americans with Disability Act) requirement for side reach using a wheelchair. What will be the maximum reachable height or the value of "X"?

B. 760 mm (30 in)

C. 864 mm (34 in)

D. 1170 mm (46 in)

E. 1220 mm (48 in)

F. 1370 mm (54 in)

Answer(s): E

3. A telephone facility and an electrical facility are required in a tunnel. To reduce the effects of EMI and eliminate the need for additional shielding of the cables, where would each facility be placed?

A. On opposite sides of the tunnel

B. On the same sides of the tunnel

C. Together on the same pathway for easy access and maintenance

D. One on the top part and one on the bottom part of the same side of the tunnel
E. On the exterior of the tunnel

Answer(s): A

4. Exhibit:

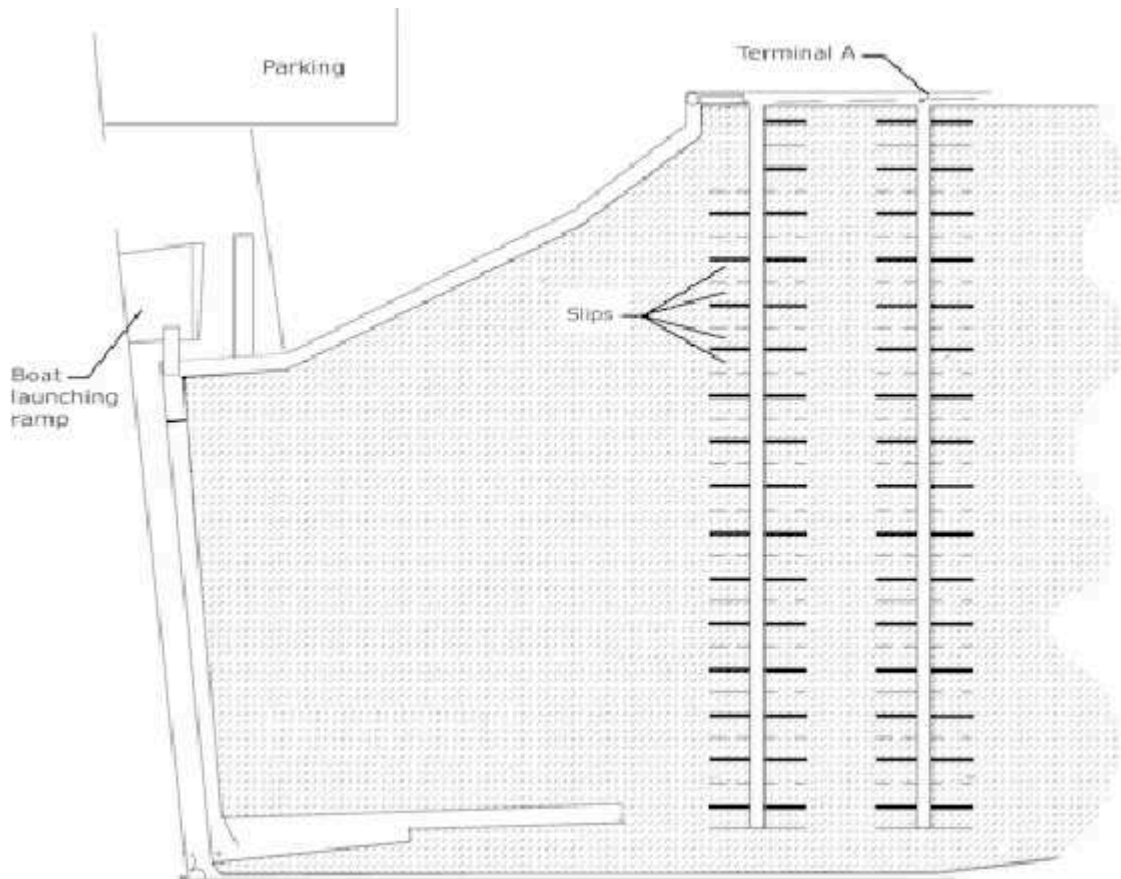

In this future marina layout, what would be the pre-cabing guideline to follow for the terminal A?

- A. Place distribution cable onto the dock and terminate in a suitable cabinet or enclosure. Run service drop to each boat slip.
- B. Provide one or two pair cables from the boat slips to a distribution terminal on the closest point of land.
- C. Pre-cable each boat slip during construction.
- D. For security, each run should be terminated in the patch panel/ cross-connect at the dockmaster or marina office.

Answer(s): A

5. Which type of protection for electrical power stations provide isolation against a rise in potential of station ground and also provide drainage protection against longitudinally-induced voltages?

- A. Isolating transformers
- B. Neutralizing transformers

C. Mutual drainage reactors

D. Unit-type neutralizing transformers

E. 2-winding neutralizing transformers

Answer(s): A

6. Exhibit:

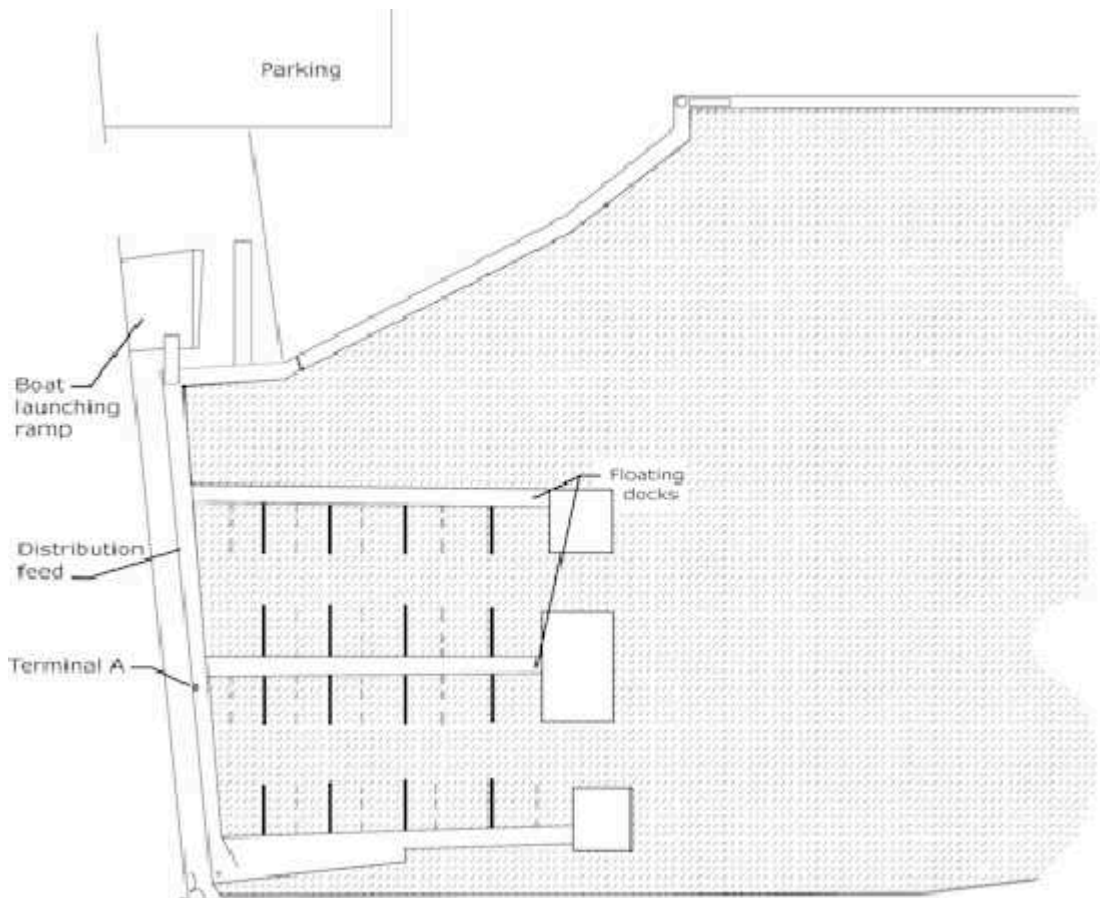

In this future marina layout, assuming that there are fewer than 10 slips being cabled, what would be the pre-cabling guideline to follow for terminal A?

A. Installed one or two pair cables from the boat slips to a distribution terminal on the closest point of land.

B. Place distribution cable onto the dock and terminate in a suitable cabinet or enclosure. Install service drop to each boat slip.

C. Pre-cable each boat slip during construction.

D. For security, each install should be terminated in the patch panel/cross-connect at the dockmaster or marina office.

Answer(s): A

7. What is the air change requirement for a tunnel of 610 m (2000 ft) long with a diameter of 3.4 m (11 ft)?

A. One complete air change per hour

B. Two complete air changes per hour

C. Three complete air changes per hour

D. Four complete air changes per hour

E. Five complete air changes per hour

Answer(s): C

8. In new construction, what is the percentage of pay phones that must be equipped with volume controls?

A. 4

B. 10

C. 25

D. 35

E. 50

Answer(s): C

9. Exhibit:

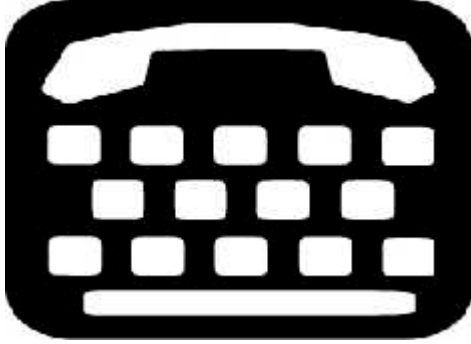

What does this international symbol stands for?

A. Teletypewriter/text telephone

B. Public internet station

C. Public telephone

D. Public telephone with a shelfette

E. Public telephone with access to high-speed internet connection

Answer(s): A

10. Coupling with electrical circuits can create inductive interference to telecommunications facilities.

Which of the following can decrease the coupling effect?

A. Decrease the exposure length

B. Make sure that the single-phase components add in phase

C. Decrease the physical separation

D. Increase the earth resistance

Answer(s): A

11. One interior TTY must be provided at locations defined as public accommodations with _____ or more pay telephones.

A. One

B. Two

C. Four

D. Six

E. Eight

Answer(s): C

12. In an office area, a consultant needs to add the location of a fax machine to the plan. What is the approximated floor area that a fax machine occupies?

A. 0.2 sq m (2 sq ft)

B. 0.5 sq m (5 sq ft)

C. 1 sq m (10 sq ft)

D. 1.5 sq m (16 sq ft)

E. 2 sq m (20 sq ft)

Answer(s): C

13. What is the MINIMUM distance from the edge of a pool or other water hazards for a weatherproof enclosure?

A. 1 m (3 ft)

B. 2 m (7 ft)

C. 4 m (13 ft)

D. 6 m (20 ft)

E. 10 m (30 ft)

Answer(s): D

14. You are designing distribution for a seven unit townhouse with in slab conduits. What is the MINIMUM number of 27 mm (1 in) rigid PVC Type 2 or metallic conduit that is required to satisfy distribution to each unit?

A. Three

B. Four

C. Five

D. Seven

E. Fourteen

Answer(s): D

15. You have just finished a design calling for 15 telecommunications outlets. You received word that the owner has increased his requirements by 40%.

What size commercial DD (distribution device) is required to accommodate the increase?

A. 660 mm (26 in)

B. 1015 mm (40 in)

C. 1346 mm (53 in)

D. 1676 mm (66 in)

Answer(s): C

16. Which service is NOT typical of Grade 1?

A. Telephone

B. Multimedia

C. Data

D. Television

Answer(s): B

17. You are designing a multi-story dwelling and need to place the CTR's. Every floor is not available.

What is the alternate spacing for the CTRs?

A. Every 2 floors

B. Every 3 floors

C. Every 4 floors

D. Every 5 floors

E. 1st floor and midway up through the height of the building

Answer(s): B

18. You are designing a system requiring the transmission of dat

A. Your system must perform higher than _____ kHz in order to do so.

B. 4

C. 8

D. 10

E. 16

F. 32

Answer(s): C

19. To accommodate telephone, data, CATV, security and multimedia, a MINIMUM of _____ strands of optical fiber auxiliary disconnect outlet (ADO) cable should be provided.

A. Two

B. Four

C. Five

D. Six

E. Eight

Answer(s): B

20. Which type of scheduling chart utilizes predecessor and successor relationships when identifying tasks?

A. PERT

B. Calendar

C. Milestone

D. Gantt

Answer(s): A
